

Method Statement for Application "SIKA EGYPT" **Sikaflex® 11 FC**

Construction

Scope: *Fast moisture Curing, 1 Part PU Sealant / Adhesive with high modulus flexibility for indoor & outdoor applicatio*

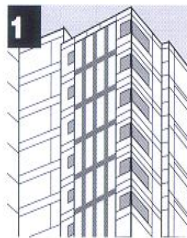

1 TYPICAL FIELD OF APPLICATION

Sealing of metal and timber cladding
Connection joints between floor and machinery, at windowsills, stairs, steel sheet piles and sealing of pipe ducts.



2 SUBSTRATE PREPARATION

The substrate must be of sufficient strength, dense, clean, dry and free of oil, fat and loose particles. Cement slurry and other loosely adhering particles on joint sides should be removed. Paints and coatings covering the joint sides must be compatible with **Sikaflex-11 FC**.

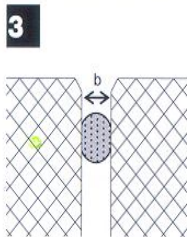

3 BACKING ROD

Joint width [mm]	10	15	20	25	30
Ø [mm]	13	20	25	30	40

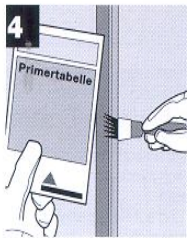

4 PRIMER

Refer to our Primer Chart. Use **Primer 3** for cementitious, absorbent substrates. Use **Sika Primer 35** for Steel substrates.

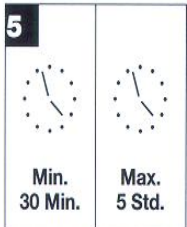

Wait for minimum 15-30 minutes, depending on the Primer used before applying **Sikaflex 11 FC**.

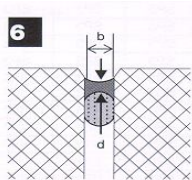

5 JOINT PROFILE

Joint width (b) [mm]	10	15	20	25	30
Joint depth (d) [mm]	10	10	12	15	15

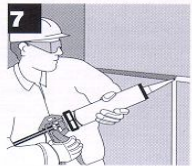

6 APPLICATION

Apply with a caulking gun. Smoothen with a spatula and by using water (1-2 drops of soap).



7 CONSUMPTION

Joint width [mm]	10	15	20	25	30
Length [m] per 600cc	7.5	4	2.5	1.6	1.3

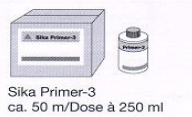

8 CONSUMPTION OF PRIMER

Approx. 50 m per 250 ml, depending on Primer used.

Cleaning

Clean tools and equipment with **Colma Cleaner** immediately after use. Cured material can only be removed mechanically.

Safety

Health and safety instructions on the latest Technical Data Sheet must be strictly observed.

For any additional information, please do not hesitate to consult our Technical Services Department.

Technical Department

